

Rail Installation

- 1) Remove the speaker from the packing materials and the foam shipping blocks from the wood rails. On larger models when instructed to leave the foam blocks intact please **do not remove**. These foam blocks are used to support longer wingspan rail systems. The foam blocks will compress as you slowly hand tighten. (see instruction #7)

- 2) Using the provided wood template, cut a rectangular opening into the desired section of the wall. Push any fiberglass insulation aside while keeping as much as possible within the opening to allow the speaker to easily fit into the opening

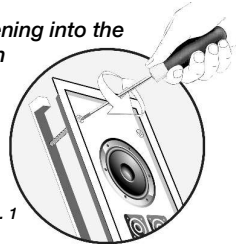

- 3) Remove the speaker grille and loosen the front panel bolts, 2 - 3 turns only counterclockwise (See Fig. 1)

- 4) Slide the bottom end of the speaker into the wall until the bolts are resting on the openings bottom edge (See Fig.2)

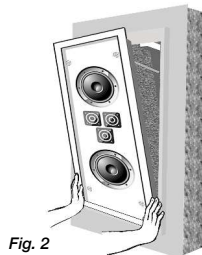

- 5) Connect the wires to the spring terminals located on the back of the speaker

- 6) Push the speaker assembly into the top section of the opening allowing the top ends of the rails to slide behind the top of the wall. Lift the bottom edge of the speaker until the frame is FLUSH with the wall on all four sides (See Fig. 3)

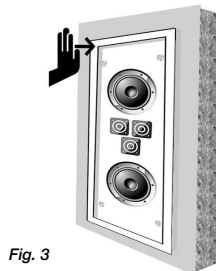

- 7) Tighten the four front panel machine screws by hand clockwise until the rails catch and securely engage the back of the drywall. Tighten each screw a few turns going around the speaker in order to apply even force to the back of the speaker. Do not use a drill! (See Fig. 4)

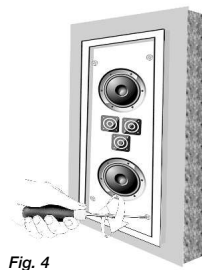

- 9) Replace the Grille

Dog-Ear Installation

- 1) Remove the speaker from the packing materials
- 2) Using the provided wood template, cut a rectangular opening into the desired section of the wall. Push any fiberglass insulation aside while keeping as much as possible within the opening to allow the speaker to easily fit into the opening

- 3) Remove the speaker grille exposing the dog-ear engagement screw

- 4) Make sure that the dog-ear clamps are at their lowest position (Diagram A) and are in-line with the dog-ear assembly, not off to the side (Fig. 1)

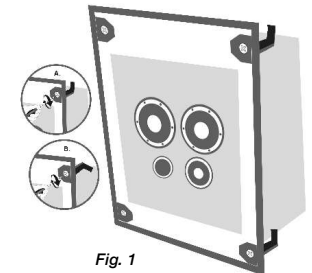

- 5) Bring the connection wires forward and connect the wires to the spring terminals located on the back of the speaker

- 6) Place the speaker into the opening in the wall so that the frame is FLUSH with the wall and slowly begin to tighten the dog-ear engagement screws (Fig. 2)

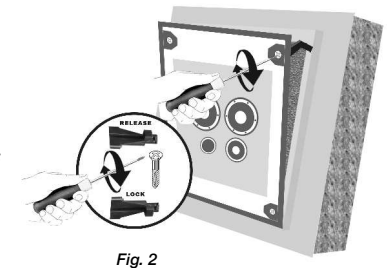

- 7) As you tighten the screws, the dog-ear clamp will rotate out (Diagram B/C) from the assembly and rise up the track (Diagram D) securely engaging the back of the drywall (Fig. 3)

- 8) Do Not over-tighten the engagement screws as extreme force may cause the dog-ear assembly to break

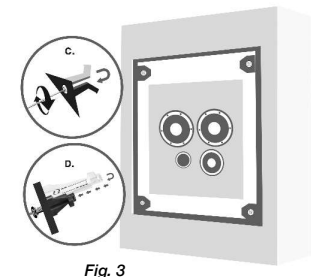

- 9) If the dog-ear clamps fail to securely engage the back of the drywall, use the provided wood extenders w/ felt pads to lengthen the clamps and repeat the tightening steps

- 10) Replace the grille